

One-Bedroom

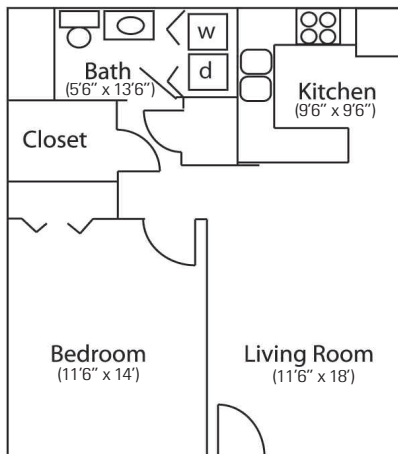

Two-Bedroom

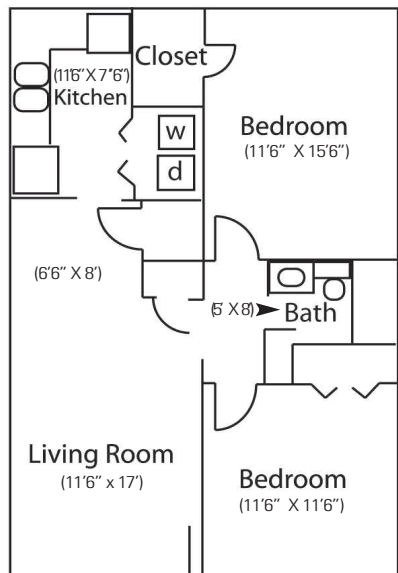

Convenient Location:

- 4.36 miles from UA
- 10.77 miles from Shelton State
- Next to Essex Square Marketplace and near major commercial areas



Essex Square

apartment homes

"Where You Get So Much More For So Much Less"



Essex Square

Office Hours: Mon-Fri 9 a.m. - 5 p.m.

Phone: 205.758.7144

Fax: 205.391.0388

Email: essexsq@duckworth.com

Website:

www.duckworth.com/apartments/dmgessex.shtml



Essex Square

apartment homes

"Where You Get So Much More For So Much Less"

3550 Watermelon Road • Northport, Alabama 35473

A Duckworth-Morris Real Estate Property

Essex Square

apartment homes

FEATURES:

- On Site Resident Manager
- 24/7 Maintenance
- Energy Saving
- Gated/Coded Entry System
- Washer and Dryer Connections
- Major Kitchen Appliances:
(Refrigerator, Range, Dishwasher)
- Garbage Disposal
- Ceiling Fans
- Blinds
- Carpeting Throughout
- Cable TV Available
- Central AC/Heating

AMENITIES:

- Serene Pavilion
- Private Pool
- Well-lit Basketball Court
- Well-lit Tennis Court

SCHOOL ZONES:

- Faucet Vestavia Hills Elementary
- Riverside Middle School
- Tuscaloosa County High School

